

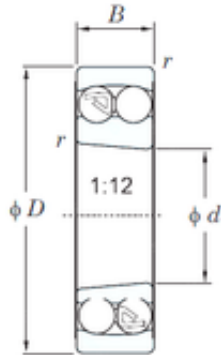

SKF BEARING MANUFACTURING CO.,LTD.



80 mm x 140 mm x 26 mm KOYO 1216K self aligning ball bearings

Bearing No. 1216K

1216K Bearing 2D drawings and 3D CAD models

Size	80x140x26 mm
Bore Diameter	80 mm
Outer Diameter	140 mm
Width	26 mm
d	80 mm
D	140 mm
B	26 mm
C	26 mm
r min.	2 mm
da min.	89 mm
Da max.	131 mm
ra max.	2 mm
Weight	1.64 Kg
Basic dynamic load rating (C)	39.8 kN
Basic static load rating (C0)	17.0 kN
(Grease) Lubrication Speed	4000 r/min
(Oil) Lubrication Speed	4900 r/min
Calculation factor (e)	0.16
Calculation factor (Y0)	4.08
Calculation factor (Y1)	3.90
Category	Self Aligning Ball Bearings
Inventory	0.0
Manufacturer Name	KOYO
Minimum Buy Quantity	N/A
Weight / Kilogram	0



SKF BEARING MANUFACTURING CO.,LTD.

EAN	0605790001314
Product Group	B00152
Mounting Method	Tapered Adapter
Enclosure	Open
Rolling Element	Ball Bearing
Adapter Sleeve	H-216X
Cage Material	Steel
Precision Class	ABEC 1 ISO P0
Internal Clearance	C0-Medium
Number of Rows of Balls	Double Row
Other Features	Allowable Misalignment 2.5 Deg 1:12 Taper
Long Description	80MM Bore; Tapered Adapter Mount; 140MM Outside Diameter; 26MM Inner Race Width; 26MM Outer Race Width; Open; Steel Cage; Double Row of Balls; ABEC 1 ISO P0; C0-Medium
Inch - Metric	Metric
Category	Self Aligning Ball Bearings
UNSPSC	31171532
Harmonized Tariff Code	8482.10.50.68
Noun	Bearing
Keyword String	Self Aligning
Manufacturer URL	http://www.koyousa.com
Weight / LBS	3.61558
Bore	3.15 Inch 80 Millimeter
Inner Race Width	1.024 Inch 26 Millimeter
Outer Race Width	1.024 Inch 26 Millimeter
Outside Diameter	5.512 Inch 140 Millimeter